

Project Documentation | SHIELD Data Sheet

Project Number:

...

SMS Project Number:

...

Project Title:

UMRR

Keyword(s):

Shield, Rain Cover, Snow Cover, Weather Cover

Date:

November 30, 2018

Document:

SHIELD Data Sheet.docx

Document state:

In progress

Ready for review

X Released

Outdated

PROPRIETARY

The information contained in this document may be subject to change without notice.

The information contained in this document shall remain the sole exclusive property of s.m.s smart microwave sensors GmbH.

1 Contents

1	Contents	2
2	Reference Documents	3
3	User Safety Warning Information	4
4	Shield-050000	5
4.1	General Data	6
4.2	Compatible UMRR Sensors.....	6
4.3	Mounting Instruction	7
4.3.1	Hardware installation	7
5	Important Legal Disclaimer Notice	10
6	Contact	11

PROPRIETARY

The information contained in this document may be subject to change without notice.

The information contained in this document shall remain the sole exclusive property of s.m.s smart microwave sensors GmbH.

2 Reference Documents

No.	Document	SVN-ID	Notes
[1]			
[2]			
[3]			
[4]			
[5]			

Table 1: Reference documents

The change history can be seen in the log messages in the Version Management Tool "Subversion", which is used by Smartmicro.

Path:

svn://svnrepo/Repository_UMRR_Dokumente/trunk/Kundendokumentation/TM/Datenblätter/
Komplett/SHIELD Data Sheet.docx

PROPRIETARY

The information contained in this document may be subject to change without notice.

The information contained in this document shall remain the sole exclusive property of s.m.s smart microwave sensors GmbH.

3 User Safety Warning Information

Read the instructions carefully before you start to work.

Installation

Please observe the following advices when mounting the shields:

- Only use provided or approved equipment for installation.
- Only skilled and instructed persons shall install and connect the devices.
- Only use fully functional equipment (ladders, aerial work platform, ...) when working above ground. Staff shall be capable of working at heights.
- Use caution when installing the devices on or around active roadways. Pay attention to moving traffic.
- Mount the shields carefully to prevent them from shifting or dropping.
- The devices must be mounted to a stiff and solid support. Vibration, oscillation or any kind of movement will reduce the sensor performance.
- Make sure that your installation methods are in accordance with local safety policy and procedures and company practices.

Operation

The shields are designed to work under different environment conditions (temperature, rain, dust, ...). Regular maintenance such as cleaning or recalibration is not required.

PROPRIETARY

The information contained in this document may be subject to change without notice.

The information contained in this document shall remain the sole exclusive property of s.m.s smart microwave sensors GmbH.

4 SHIELD-050000

The SHIELD-050000 is a snow and rain cover aimed to protect the sensor radome surface from accumulation of rain droplets, snow or ice. The amount of accumulation by such material is diminished. However, the SHIELD-050000 is not intended to serve as a full enclosure and will therefore not prevent all accumulation of such materials.

The SHIELD-050000 is depicted in Figure 3-1 below.
The list of compatible UMRR sensors is given in section 4.1.



Figure 4-1: SHIELD-050000

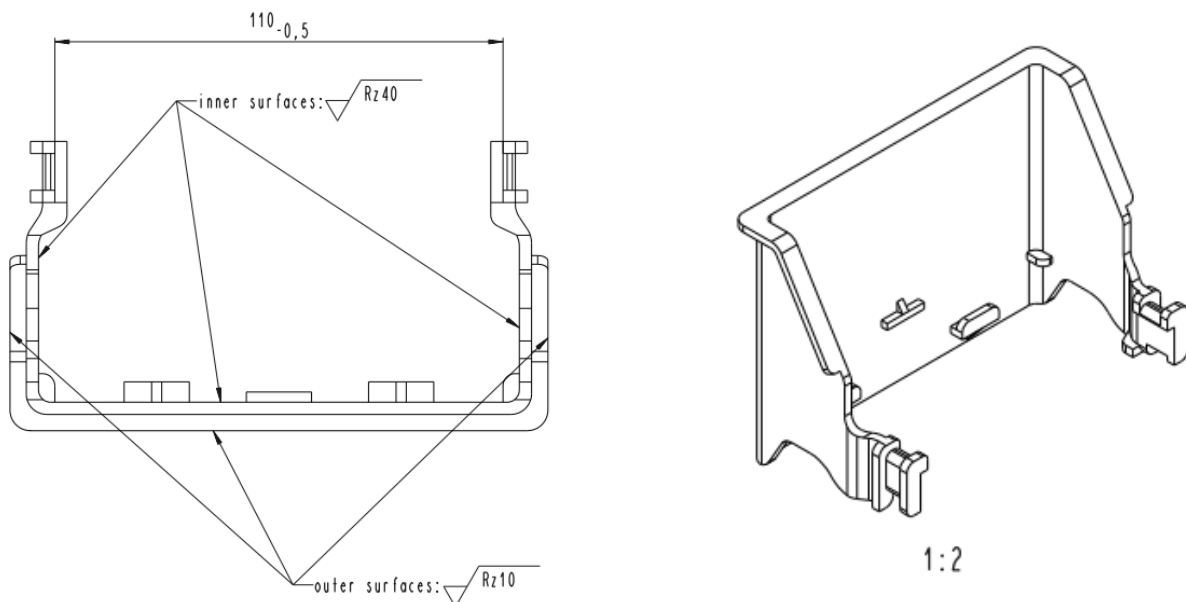

Figure 4-2: SHIELD-050000 drawing

PROPRIETARY

The information contained in this document may be subject to change without notice.

The information contained in this document shall remain the sole exclusive property of s.m.s smart microwave sensors GmbH.

4.1 General Data

Parameter	Value
Dimensions	132mm x 93mm x 90mm
Material	PBT GF

Table 1: SHIELD-050000 general data

4.2 Compatible UMRR Sensors

The SHIELD is compatible with the following UMRR sensors:

Variant	Supported UMRR
SHIELD-050000	UMRR-0A Type 29 UMRR-0A Type 30 UMRR-0F Type 29 UMRR-0F Type 30 UMRR-11 Type 44 UMRR-11 Type 45

Table 2: Compatible UMRR sensors for SHIELD-050000



PROPRIETARY

The information contained in this document may be subject to change without notice.

The information contained in this document shall remain the sole exclusive property of s.m.s smart microwave sensors GmbH.

4.3 Mounting Instruction

The following components are needed to get started:

Installation	
<p>Bracket-05xxxx or Bracket-03xxxx</p> <p>Image shows a Bracket-050400</p>	
<p>SHIELD-050000</p>	

4.3.1 Hardware installation

The following pictures shows a mounted sensor in the bracket, but a sensor is not needed to assembly the Shield-050000. It is for illustrative purposes only.

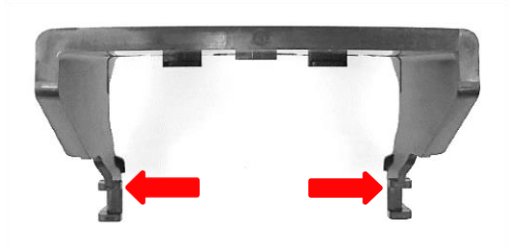
<p>1. Pull the shield apart at the red arrows.</p>	
--	--

PROPRIETARY

The information contained in this document may be subject to change without notice.

The information contained in this document shall remain the sole exclusive property of s.m.s smart microwave sensors GmbH.

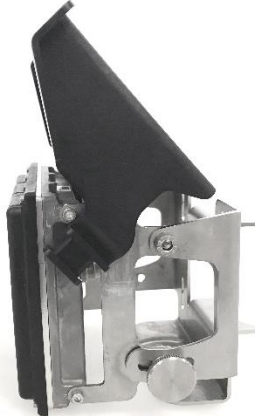
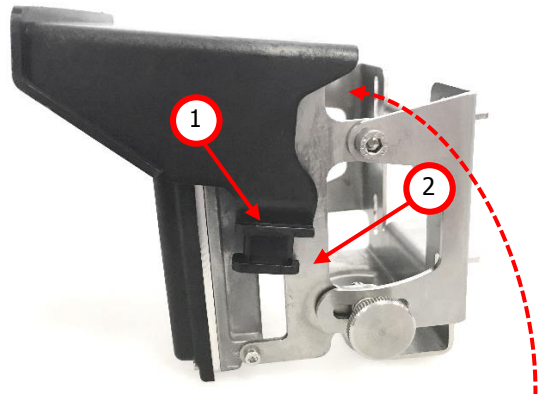
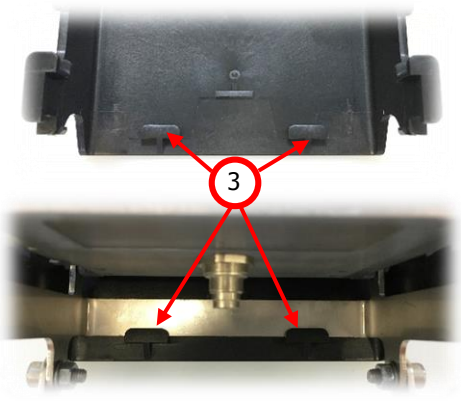
<p>2. Put the shield at the same angle as the right picture on the Bracket-05xxxx.</p>	
<p>3. Put the shield slightly downwards but make sure that the arms (1) don't lock at the shield (2).</p>	
<p>4. Lead the shield in front of the two noses (3)...</p>	

PROPRIETARY

The information contained in this document may be subject to change without notice.

The information contained in this document shall remain the sole exclusive property of s.m.s smart microwave sensors GmbH.

5. ...and lock it at the Bracket-05xxxx with a "click" noise.

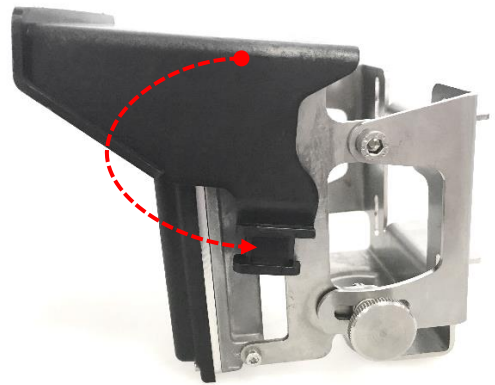

6. In the picture on the right, you can see the assembled Shield-050000.

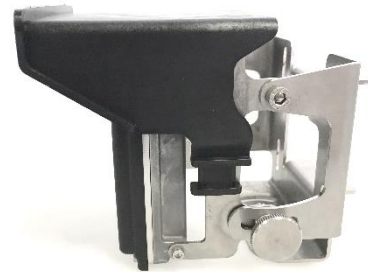

7. In regions where strong winds can be expected, secure the Shield-050000 with a metal strap at the indicated position on both sides.

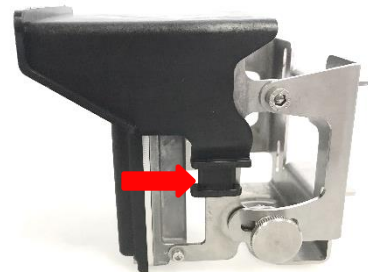

PROPRIETARY

The information contained in this document may be subject to change without notice.

The information contained in this document shall remain the sole exclusive property of s.m.s smart microwave sensors GmbH.

5 Important Legal Disclaimer Notice

This document is subject to change without notice.

The Installation Procedure/Field Test or other Procedure described herein ("Manual") is a mere recommendation or proposal by Smartmicro for installing and/or implementing and/or otherwise using the Product in generic/general applications. The recommendations and proposals contained herein are believed to be accurate as of the date hereof.

Smartmicro disclaims any and all liability for any errors, inaccuracies or incompleteness contained in this manual or in any other disclosure relating to the manual. In particular, the Manual was designed for generic/general applications and has not been adapted to a particular/specific purpose of use of the Products.

Since the Installation Procedure/Field Test or other Procedure may vary due to the specific applications and surroundings, Smartmicro makes no representations or warranties in relation to this manual or the information and test procedures provided herein.

The Manual is provided solely for informational purposes. It is the customer/user's own responsibility to validate that the application of the Product is suitable for the customers/users particular/specific purpose. The Installation Procedure /Field Test or other procedure for the Products may due to specific applications and due to specific surroundings deviate from the statements made herein. It is important that customer/user invents and certifies its own installation, test or other procedures to validate the performance of the Products in the particular/specific application before commercialization. Although Products are well optimized to be used for the intended applications stated herein, it must also be understood by the customer/user that the detection probability may not be 100 % and the false alarm rate may not be zero. In case of uncertainties with the installation, test or other procedures, the customer/user shall consult Smartmicro, a certified distributor, subsidiary or appropriate professional.

To the extent permitted by applicable law, Smartmicro disclaims (i) any and all liability arising out of the application or use of the manual or product (ii) any and all liability of damages exceeding direct damages, including - without limitation – indirect, consequential or incidental damages.

Please note that the application of the Product may be subject to standards or other regulations that may vary from country to country. We do not guarantee that the use of Products in the applications described herein will comply with such regulations in any country. It is the customer/user's responsibility to ensure that the use and installation of Products complies with the regulatory requirements of their markets.

If any provision of this Disclaimer is, or is found to be, void or unenforceable under applicable law, that will not affect the validity or enforceability of the other provisions of this Disclaimer.

PROPRIETARY

The information contained in this document may be subject to change without notice.

The information contained in this document shall remain the sole exclusive property of s.m.s smart microwave sensors GmbH.

6 Contact

For further questions or technical support, please contact Smart Microwave Sensors.

Address:

smart microwave sensors GmbH
In den Waashainen 1
38108 Braunschweig
Germany

Phone / Fax numbers:

Phone: +49-531-39023-0
Fax: +49-531-39023-599

Web / Email address:

Web: www.smartmicro.de
Email: tmteam@smartmicro.de

PROPRIETARY

The information contained in this document may be subject to change without notice.

The information contained in this document shall remain the sole exclusive property of s.m.s smart microwave sensors GmbH.